

PSB-2007-015	Date: 09 May, 2007
Title	RTV900: Front CV Joint Breakage/Failure
Group Code	ST05 – Steering Mechanical Links and Pins
Product Line	V-Tractor
Model Number (s)	RTV900

SERIAL NUMBERS AFFECTED:

10001 ~ 66026

Service Information**Subject:**

In certain types of terrain operation, excessive external force may be applied to the front axle. As a result, the steering angle can exceed the maximum limitations and cause CV joint breakage.

SOLUTION:

If operational conditions result in this breakage, Kubota recommends that when the CV joint is replaced, the new adopted steering stopper kit be installed at the same time.

Parts Information

Part Name	Part No.	Qty
Stopper Kit, Steering	K7571-91750	-
Kit consist of:		
Stopper, Steering LH	K7571-18580	1
Stopper, Steering RH	K7571-18590	1
Bolt, Flange	01754-50616	4
Plate, CV Joint Guard	K7561-18690	2
Installation Manual	K7571-91760	1

Warranty Information

Normal Warranty:

SFI-C-07-001

Stopper Kit Installation; Allowable Man-hours: **0.2****Installation Instructions****Before Servicing and Repairing**

- Park the machine on firm and level ground and set parking brake.
- Lower the implement to the ground.
- Stop the engine and remove the key.
- Disconnect the battery negative cable.
- Hang a "DO NOT OPERATE" tag in the operator station.

Installation Drawings

1. Identify the RH Stopper (K7571-18590) and LH Stopper (K7571-18580).



1. K7571-18580 Stopper, Steering LH (1)
2. K7571-18590 Stopper, Steering RH (1)
3. K7561-18690 Plate, CV Joint Guard (2)
4. 01754-50616 Bolt, Flange (4)

2. Install Stoppers using the two existing 7mm holes on the trailing side of the Lower Front Arm (A-arm) as shown in Figure 2.

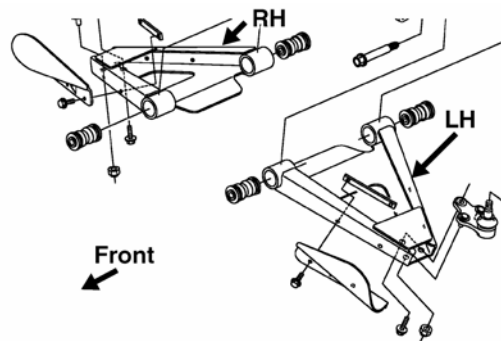

Figure 2

3. Attach CV Joint Guard Plate (K7561-18690) to the inside of the Lower Front Arm and connect the Stopper and Plate using M6 bolts (01754-50616) provided. Perform installation to both left and right Lower Front Arms.



Figure 3

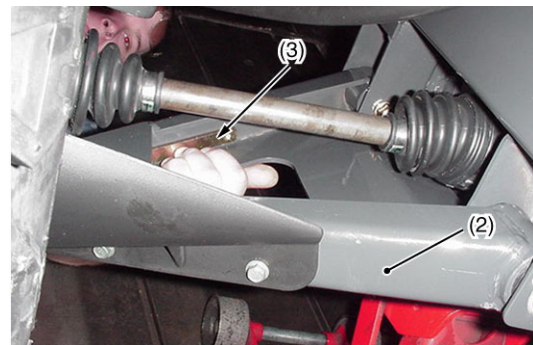

Figure 4

- (1) Stopper RH
- (2) Lower Front Arm
- (3) CV Joint Guard Plate

Tightening Torque	Stopper Mounting M6 Bolt	9.81 ~ 11.2 N-m 1.00 ~ 1.15 kgf-m 7.24 ~ 8.31 lb-ft
-------------------	--------------------------	-----------------------------------------------------------